



LTSS in our community

Money Follows the Person – Tribal Initiative, Part III

Wednesday, October 28, 2020, 2:00 p.m. eastern

If you lose connectivity during the session, simply **re-click your join link to re-access the webinar** .

If you experience technical difficulties, **send a note using the chat box** on your bottom menu bar. We'll assist you from there.

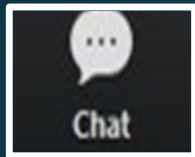

Enjoy the session!

Technical Notes and Support

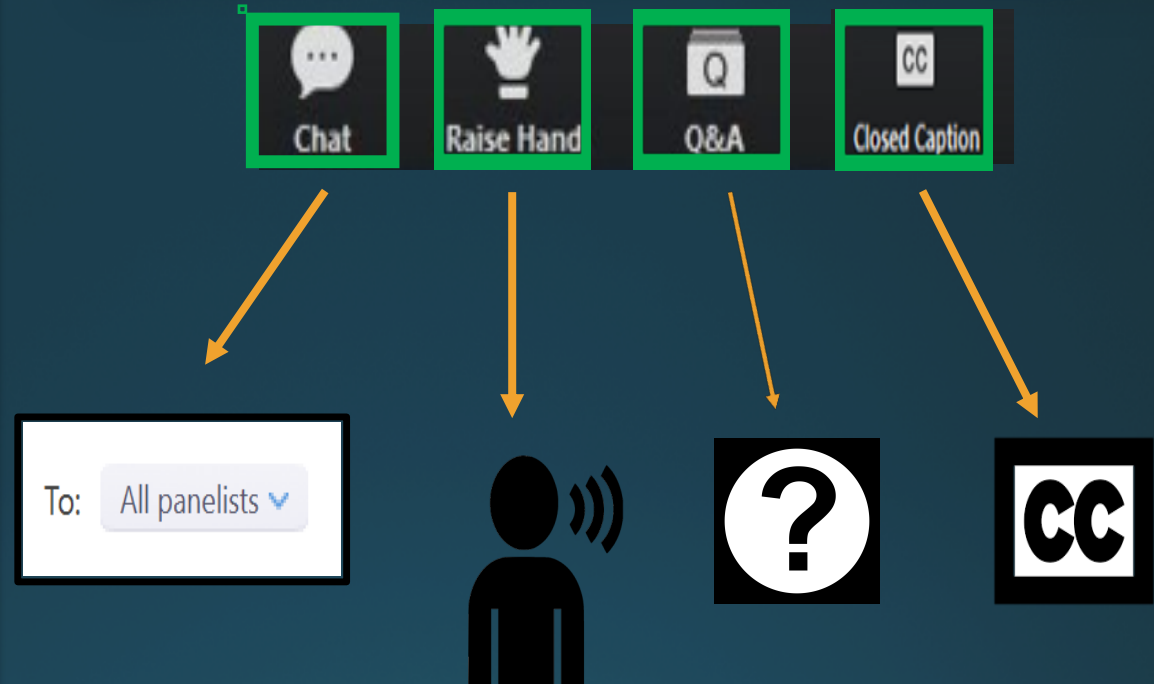



Disclaimer

This webinar series is supported by GS-00F-0012S/HHSM-500-2016-00065G awarded by the Centers for Medicare & Medicaid Services. The opinions, findings, conclusions, and recommendations expressed in this webinar are those of the presenters and do not necessarily represent the official position or policies of the Department of Health and Human Services or the Centers for Medicare & Medicaid Services.

Facilitator



Russell Coker, Ed.D
Money Follows the Person – Tribal
Initiative Director
Seminole Nation of Oklahoma

MFP – Tribal Initiative



- 2014 Money Follows the Person (MFP) funding approved by CMS
- 31 tribal nations coordinating across several levels of government
 - tribal
 - state
 - federal
 - city/urban

MFP – Tribal Initiative

Goal:

Establish sustainable and culturally appropriate long-term services and supports in tribal communities



MFP – Tribal Initiative

Principles

- Promote government-to-government relations
- Enhance tribal infrastructure
- Increase access to needed services
- Address disparities
- Design and implement effective programs
- Maximize fiscal resources



MFP – Tribal Initiative Tribal Nations

Minnesota

- Bois Forte Band of Chippewa
- Fond du Lac Band of Lake Superior Chippewa
- Lower Sioux Indian Community
- Mille Lacs Band of Ojibwe
- Red Lake Nation
- White Earth Nation



MFP – Tribal Initiative Tribal Nations

North Dakota

- Mandan, Hidatsa & Arikara Nation
- Standing Rock Sioux Tribe
- Turtle Mountain Band of Chippewa Indians



MFP – Tribal Initiative Tribal Nations

Oklahoma

- Ponca Tribe of Oklahoma
- Wichita & Affiliated Tribes



MFP – Tribal Initiative Tribal Nations and American Indian Organizations

Washington

- Chehalis Tribe
- Lummi Nation
- Makah Tribe
- Muckleshoot Tribe



MFP – Tribal Initiative Tribal Nations and American Indian Organizations

Washington (Continued)

- Nisqually Tribe
- Spokane Tribe
- Squaxin Island Tribe
- American Indian Community Center
- Seattle Indian Health Board



MFP – Tribal Initiative

Tribal Nations

Wisconsin

- Bad River Band of Lake Superior Tribe of Chippewa Indians
- Forest County Potawatomi Community
- Ho-Chunk Nation
- Lac Courte Oreilles Band of Lake Superior Chippewa
- Lac du Flambeau Band of Lake Superior Chippewa Indians
- Menominee Indian Tribe of Wisconsin



MFP – Tribal Initiative Tribal Nations

Wisconsin (Continued)

- Oneida Nation
- Red Cliff Band of Lake Superior Chippewa
- St. Croix Chippewa Indians of Wisconsin
- Sokaogon Chippewa Community
- Stockbridge-Munsee Community



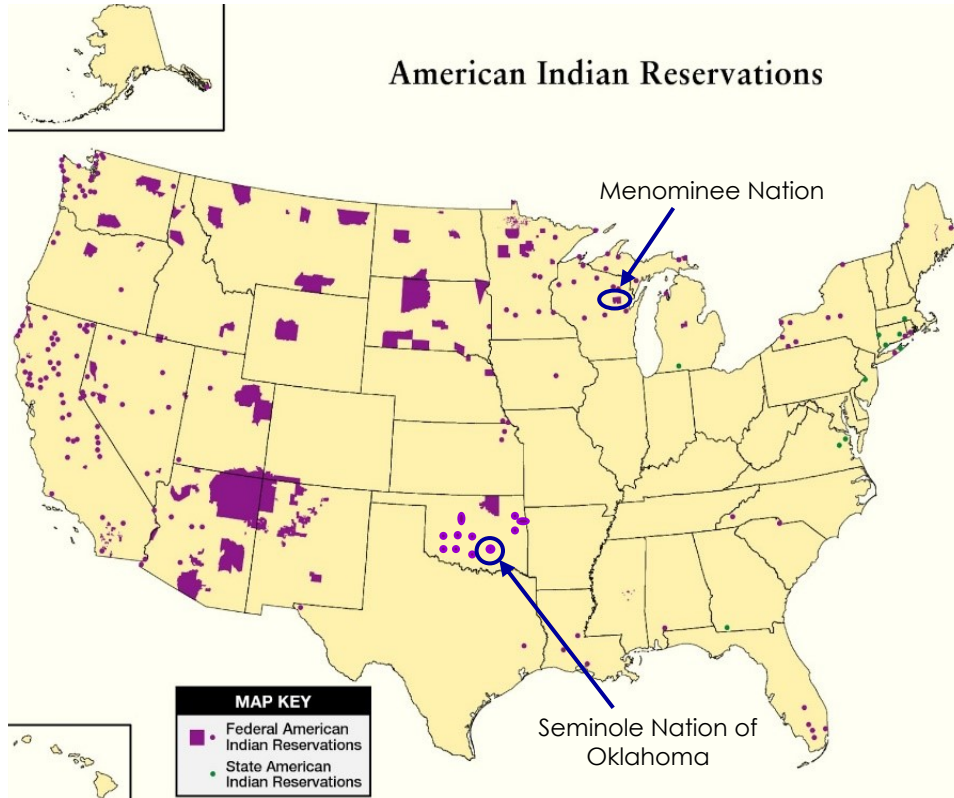



MFP – Tribal Initiative Panel

MFP – Tribal Initiative Wisconsin



Ericka Kowalkowski

Aging and Long-Term Care Director
Menominee Nation, WI

ekowalkowski@mitw.org

MFP – Tribal Initiative Wisconsin



Dawn Klaeser

Aging and Long-Term Care Director
Menominee Nation, WI

dklaeser@mitw.org



Panel Discussion



Ericka Kowalkowski

Aging and Long-Term Care
Director
Menominee Nation, WI



Dawn Klaeser

Aging and Long-Term Care
Director
Menominee Nation, WI

Opportunity to Build on the MFP – Tribal Initiative



- 570+ recognized tribal nations in 35 states
- Unique customs, traditions, culture & history

MFP – Tribal Initiative State Program Contacts

Minnesota – John Anderson
john.a.anderson@state.mn.us

Oklahoma – Russ Coker
russell.coker@okhca.org

North Dakota – Melissa
Reardon
melissa.reardon@ndsu.edu

Washington – Ann Dahl
DahlA@dshs.wa.gov

Wisconsin – Al Matano
Alfred2.Matano@dhs.wisconsin.gov



THANK YOU.
MVTO (SEMINOLE)
😊



Questions and Comments

